

# Löf Woodlands

Mansfield, CT

Löf Woodlands is an 18-acre preserve that was donated to the Trust in 2009 by John Löf. For 30 years, he tapped maple trees on the property to produce maple syrup, while his wife Ruth operated a bird-banding station where she banded over 10,000 birds.

Today the property features a mature mixed hardwood forest with some majestic oaks measuring over 20" in diameter. The half mile trail is level and mostly dry, and is appropriate for cross-country skiing as well as a pleasant woodland walk.



Joshua's Trust

Please help the Trust safeguard this preserve by following these rules:

Take only pictures and leave only footprints.

Keep dogs on leash.

NO: motor vehicles, horses, fires, or camping

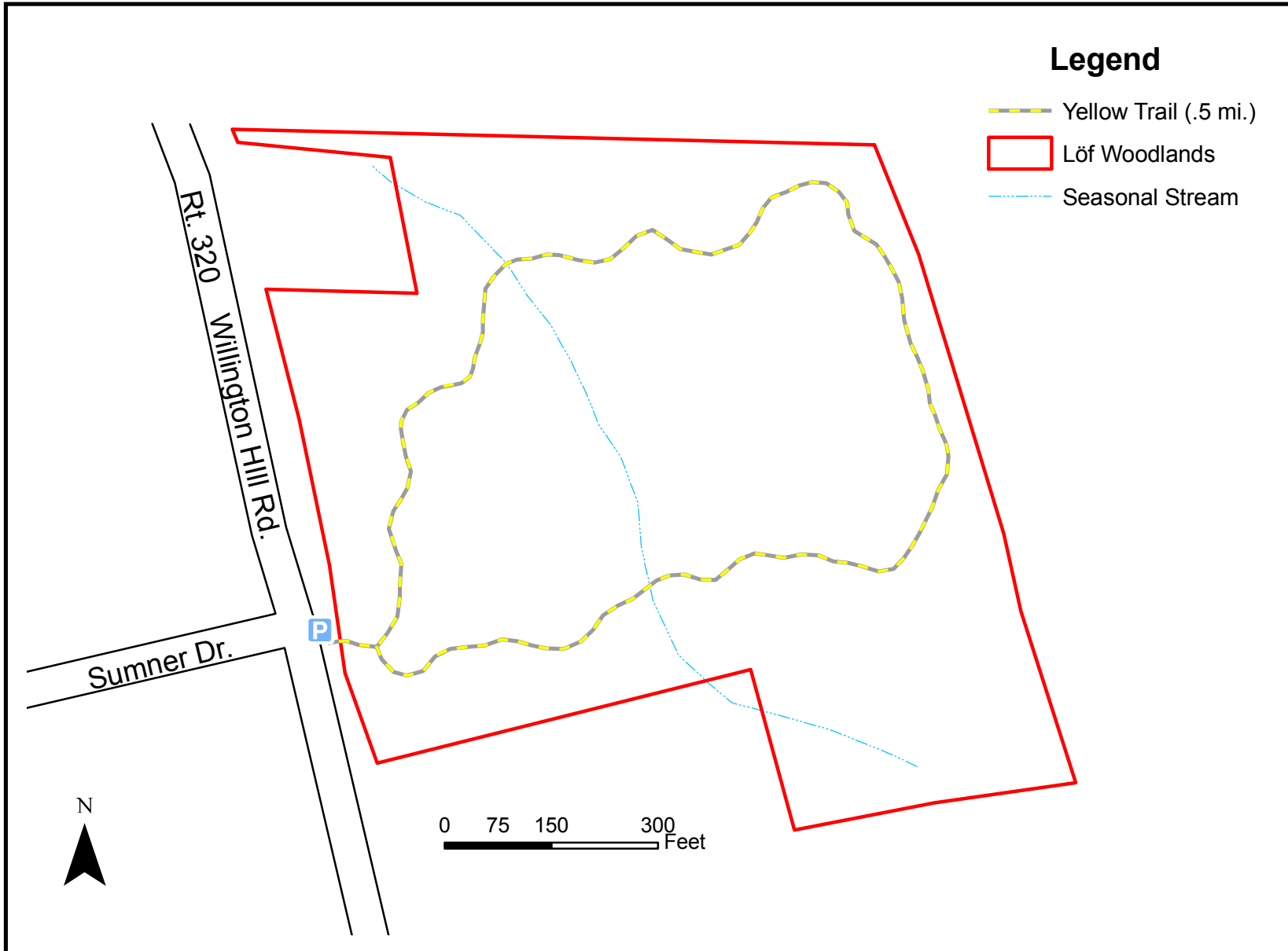

To report a problem, please contact us at: 860 429-9023 or [joshuastrust@snet.net](mailto:joshuastrust@snet.net)

Learn more about the Trust at: [joshuaslandtrust.org](http://joshuaslandtrust.org)

Location:

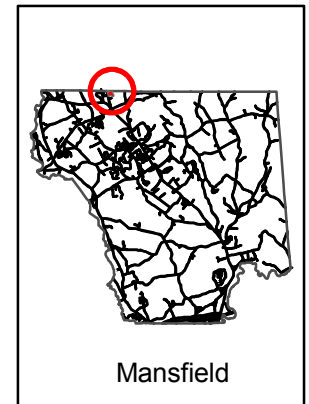

Directions: From the intersection of Rts. 44 and 195 in Mansfield, go north on Rt. 195 for 350 feet. Turn right onto Rt. 320 (Willington Hill Rd.) Go .4 miles to the parking area on the right shoulder. (Opposite Sumner Dr.)